



# Transition Slip Couplings



## PVC Schedule 40 & 80 to HDPE Conduit



Using Polywater® BonDuit® Conduit Adhesive creates a permanent watertight/airtight seal connecting PVC to HDPE.

Stronger pullout strength than most mechanical couplings.

1/2" thru 6"

Transition Couplings	
Size	Catalog #
1/2"	50 PVC/HDPE
3/4"	75 PVC/HDPE
1"	100 PVC/HDPE
1-1/4"	125 PVC/HDPE
1-1/2"	150 PVC/HDPE
2"	200 PVC/HDPE
2-1/2"	250 PVC/HDPE
3"	300 PVC/HDPE
3-1/2"	350 PVC/HDPE
4"	400 PVC/HDPE
5"	500 PVC/HDPE
6"	600 PVC/HDPE

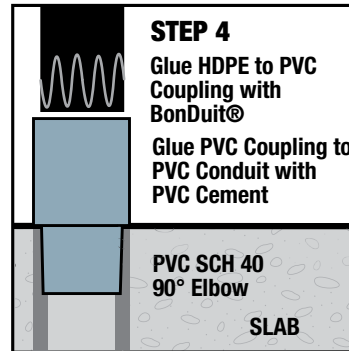
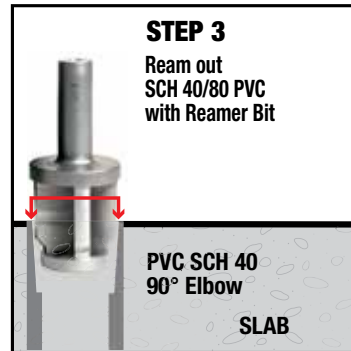
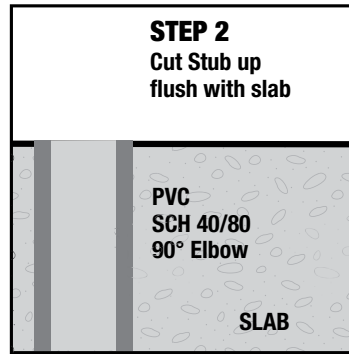
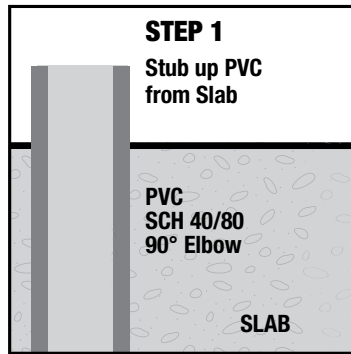

BonDuit and BonDuit XL are UL recognized and was tested to UL standard 746C.

All SP Products Inc. Transition Fittings are manufactured for installation to either meet or exceed in accordance with NEMA TC2, TC3 or UL 651 specifications

Field Application

Ream out PVC

Apply PVC Cement to

Join PVC Coupling

Apply BonDuit®

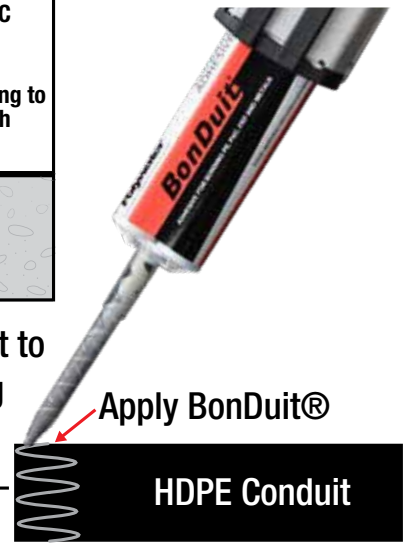
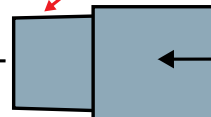

### Use On Entire Job Not Just For Repair!



PATENT PENDING  
PATENTED



LABELS APPLY TO PRODUCTS ONLY WHERE SHOWN ABOVE

730 Pratt Boulevard • Elk Grove Village, IL 60007  
P: (847) 593-8595 • F: (847) 593-8629 • Toll-free (800) 233-8595  
E: info@spproducts.com • www.spproducts.com

IP12m